



BRONX COMMUNITY BOARD #3

---

SOUTH BRONX EAST-WEST  
CROSTOWN SBS –  
BRONX/MANHATTAN

---

PROJECT ID: HWX100SBC  
BOROUGH OF THE BRONX

Zohran K Mamdani  
Mayor

Eduardo del Valle  
Acting Commissioner

2026

---

# Agenda:

- Project Limits
- Proposed Storage
- Project Goals
- Water main
- Overview: Safety Improvements
- Typical Maintenance and Protection of Traffic
- Community Impacts & Mitigation
- Community Outreach
- Project Schedule
- Q&A

# CB 3 PROJECT LIMITS



- Elton Avenue between Washington Avenue and East 163<sup>rd</sup> St.
- Washington Avenue between Elton Ave and East 163<sup>rd</sup> Street
- Est 163<sup>rd</sup> street between Brook Avenue and Washington Ave
- Intersection of Elton Avenue and Washington Avenue
- Intersection of Washington Avenue and East 163<sup>rd</sup> Street
- East 163<sup>rd</sup> Street between Washington Ave and Elton Avenue
- Intersection between Elton Avenue and East 163<sup>rd</sup> Street
- East 163<sup>rd</sup> Street between Elton Avenue and Third Avenue
- Intersection between Third Avenue and East 163<sup>rd</sup> Street
- East 163<sup>rd</sup> Street between Third Avenue and Eagle Avenue
- Third Avenue between east 163<sup>rd</sup> Street and East 164<sup>th</sup> Street
- Third Avenue between east 163<sup>rd</sup> Street and East 162<sup>nd</sup> Street
- Est 163<sup>rd</sup> Street between Tinton Avenue and Union Avenue
- Intersection of Union Avenue and East 163<sup>rd</sup> Street

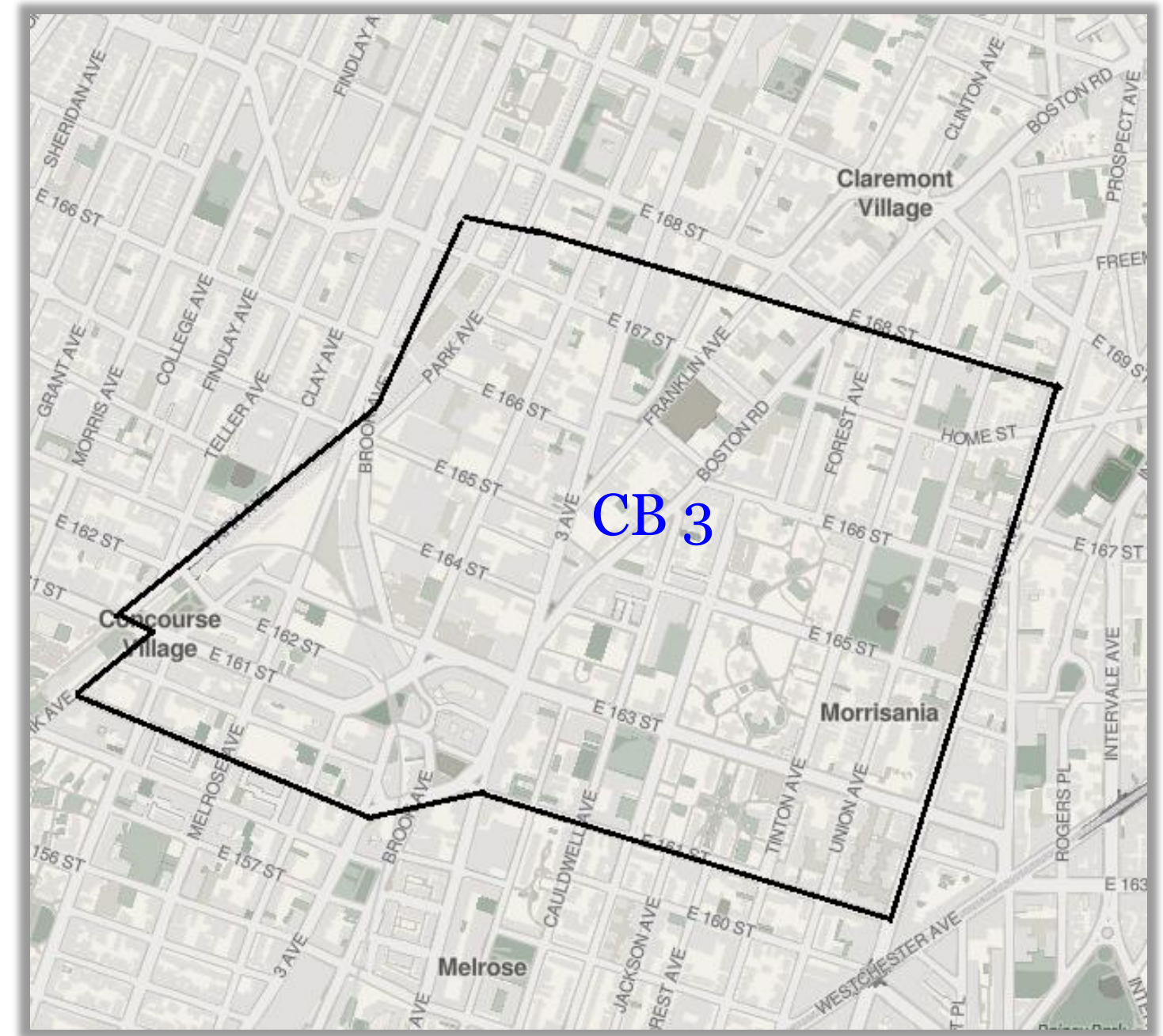

# PROPOSED PROJECT STORAGE: CB 3

- The shaded areas are tentative locations for staging. The contractor will determine once on-site if he will utilize this space.
- Though the space selected for storage is technically within CB 4 limits, it falls on the cusp of CB 3. The work continues down E 161<sup>st</sup> past Courtlandt Ave so it is an ideal location to complete work within both CB 3 & CB 4.
- Storing a portion of the items on E 161st St & Park Ave (circled Area) is ideal for the community as that location is "No Standing" and will assist with minimizing parking removal.

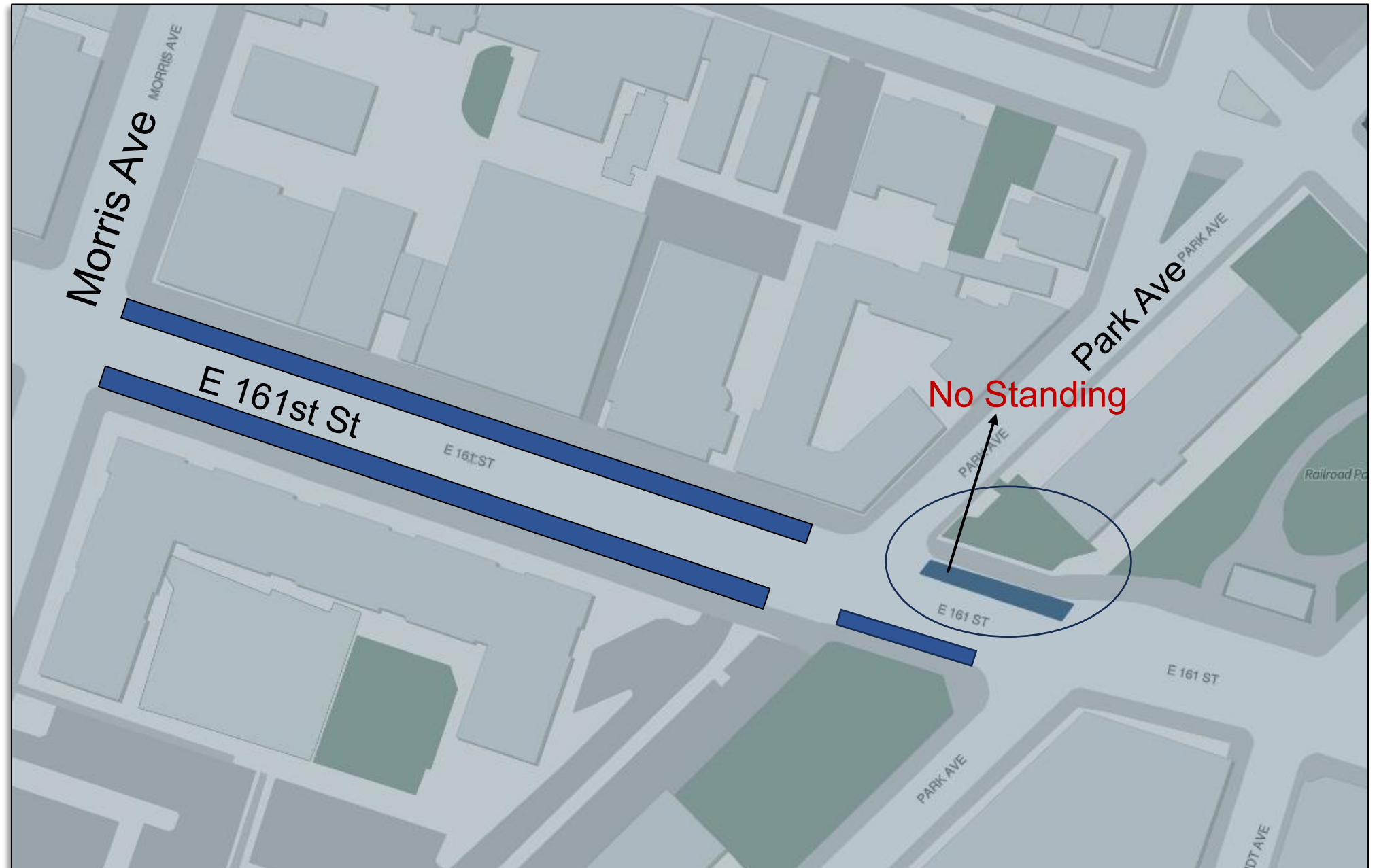

# PROJECT GOALS:

- Improve pedestrian safety with the addition of bus pads, bus bulbs, curb and median extensions, and pedestrian refuge islands.
- Install and replace hydrants, water mains, catch basins and chute connections.

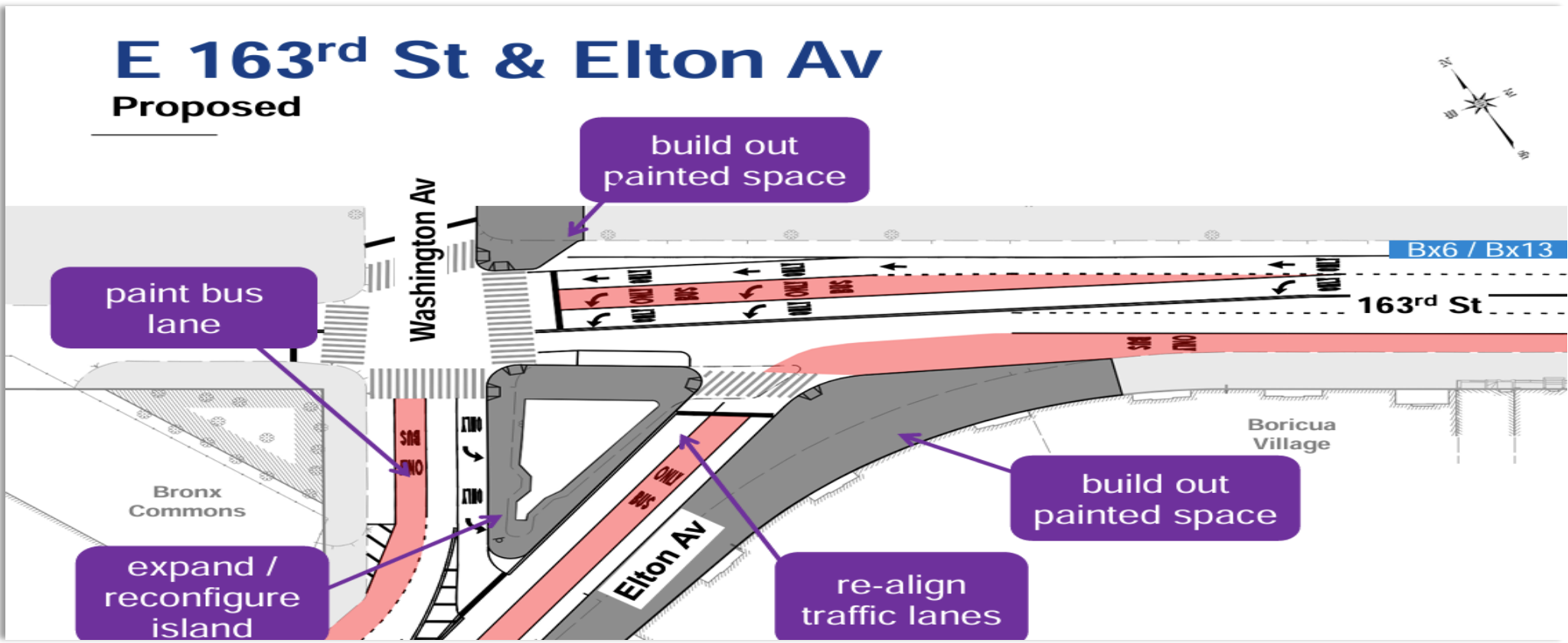
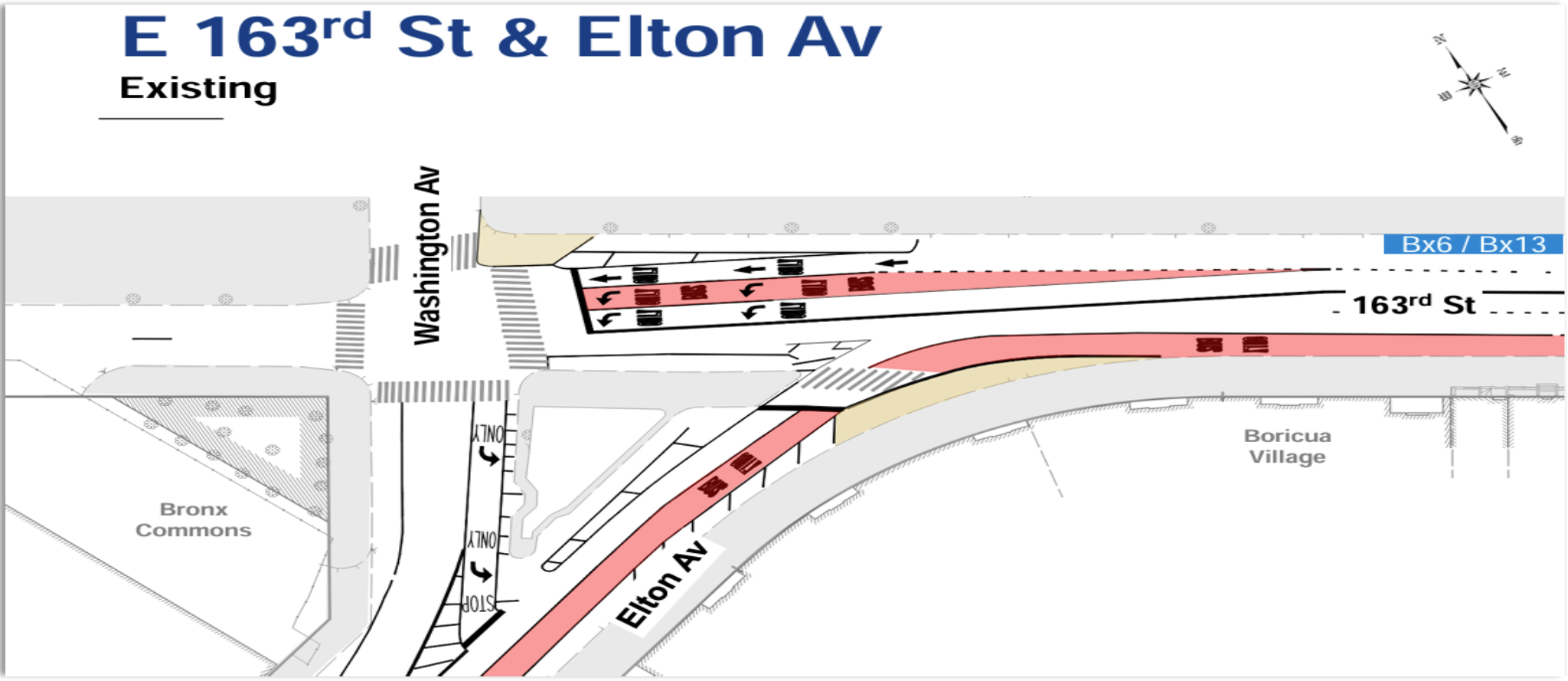

# 163<sup>rd</sup> St & Prospect Av

Existing

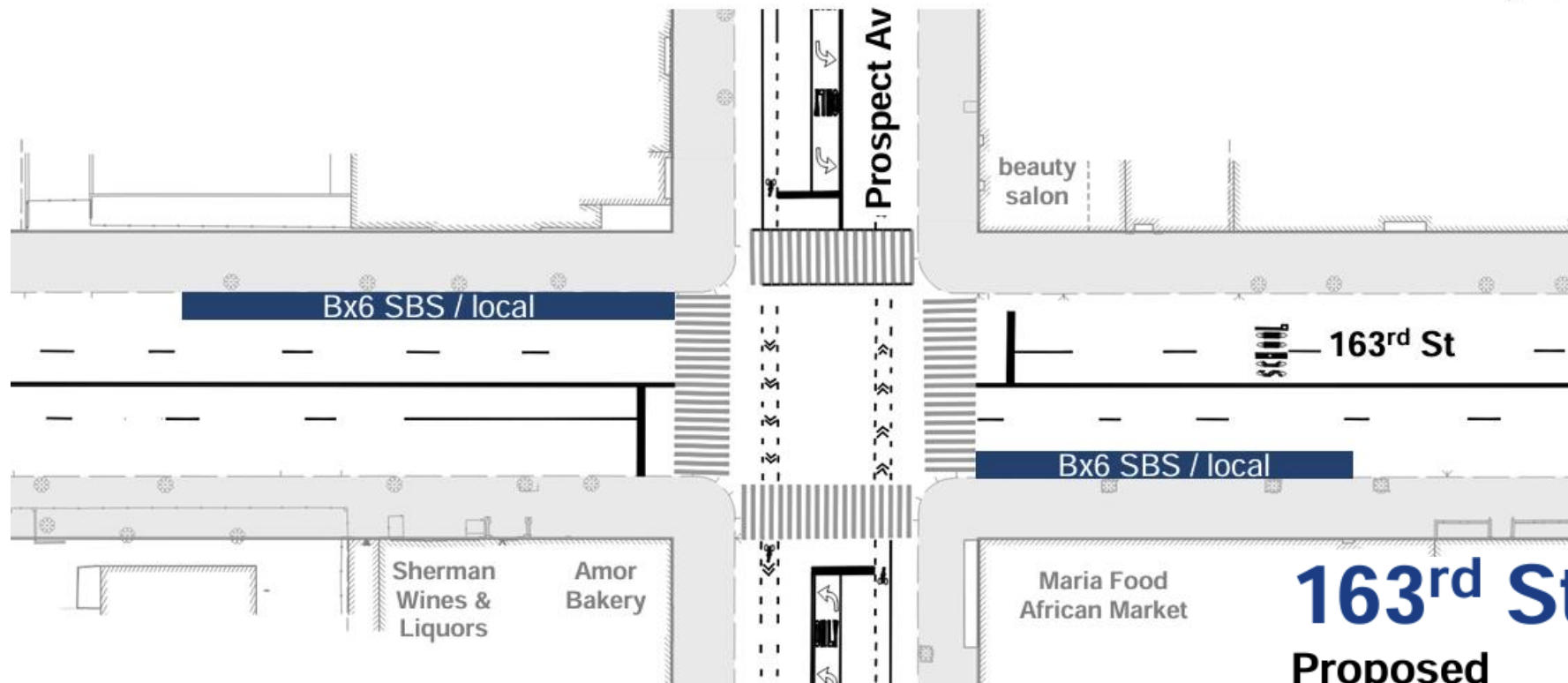

Current Conditions

# 163<sup>rd</sup> St & Prospect Av

Proposed



Proposed Conditions:

- Bus bulbs
- Curb extensions

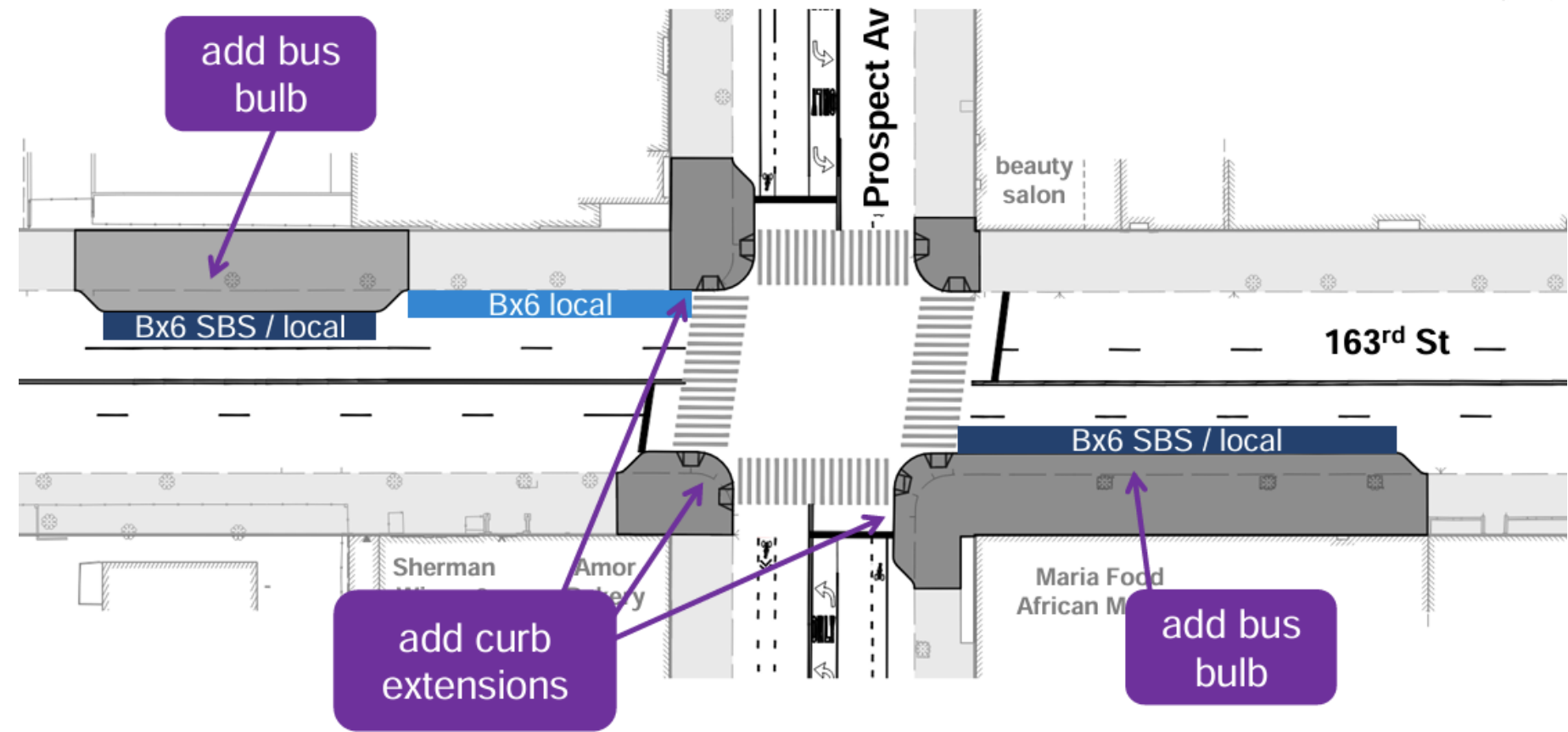

# Water main Installation within CB 3

- The water main installation will consist of a 20" and 12" main.
- The new 20" DIP (ductile iron pipe) main is to replace the existing 20" (cast iron).
- The Existing 12" main is to be removed and replaced with 12" DIP (ductile iron pipe) water main.
- Some of the work is anticipated to take place at night to minimize impact to the community.

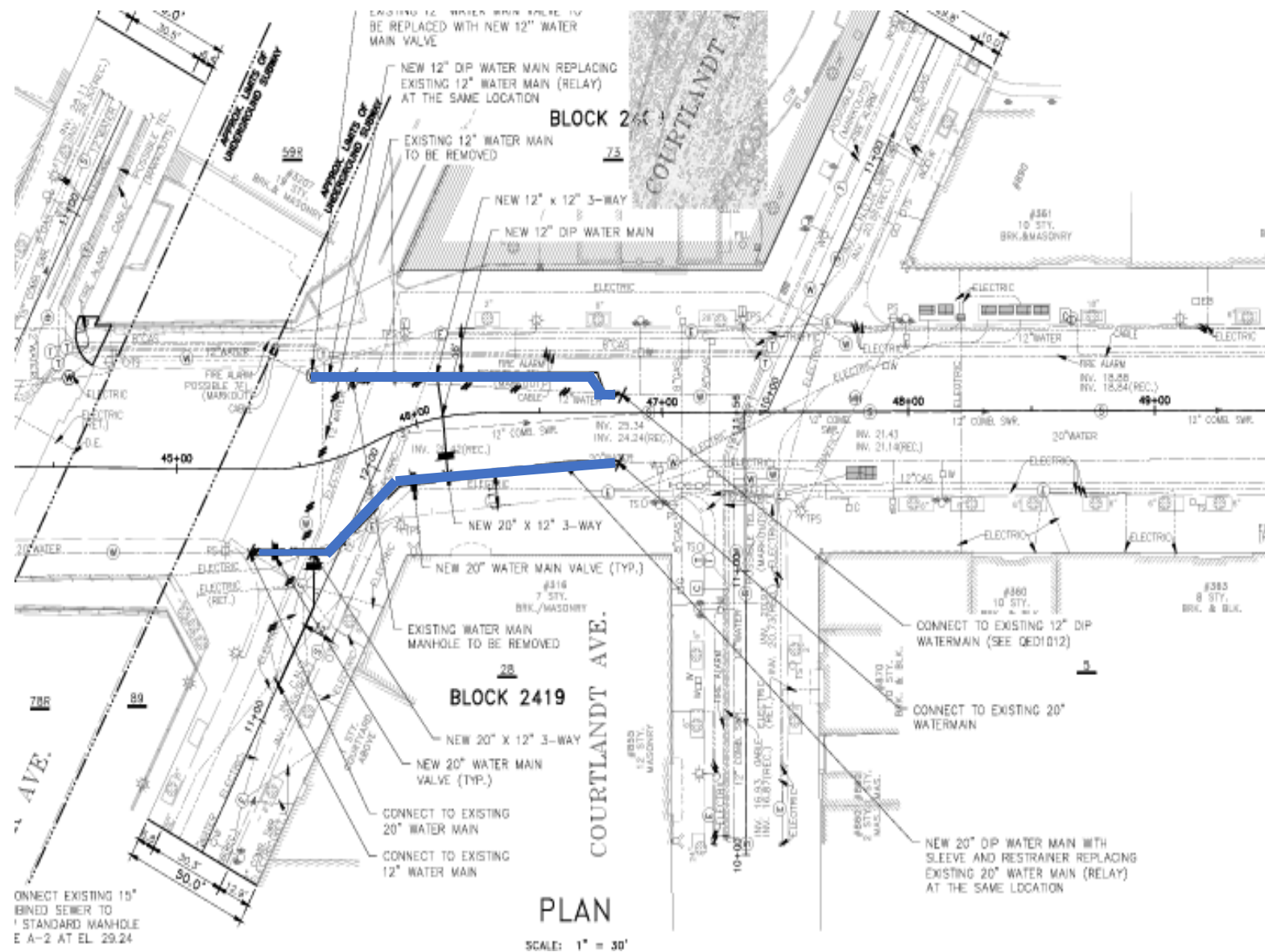

# OVERVIEW:

- The Bronx pedestrian safety improvements located in CB4 & CB3

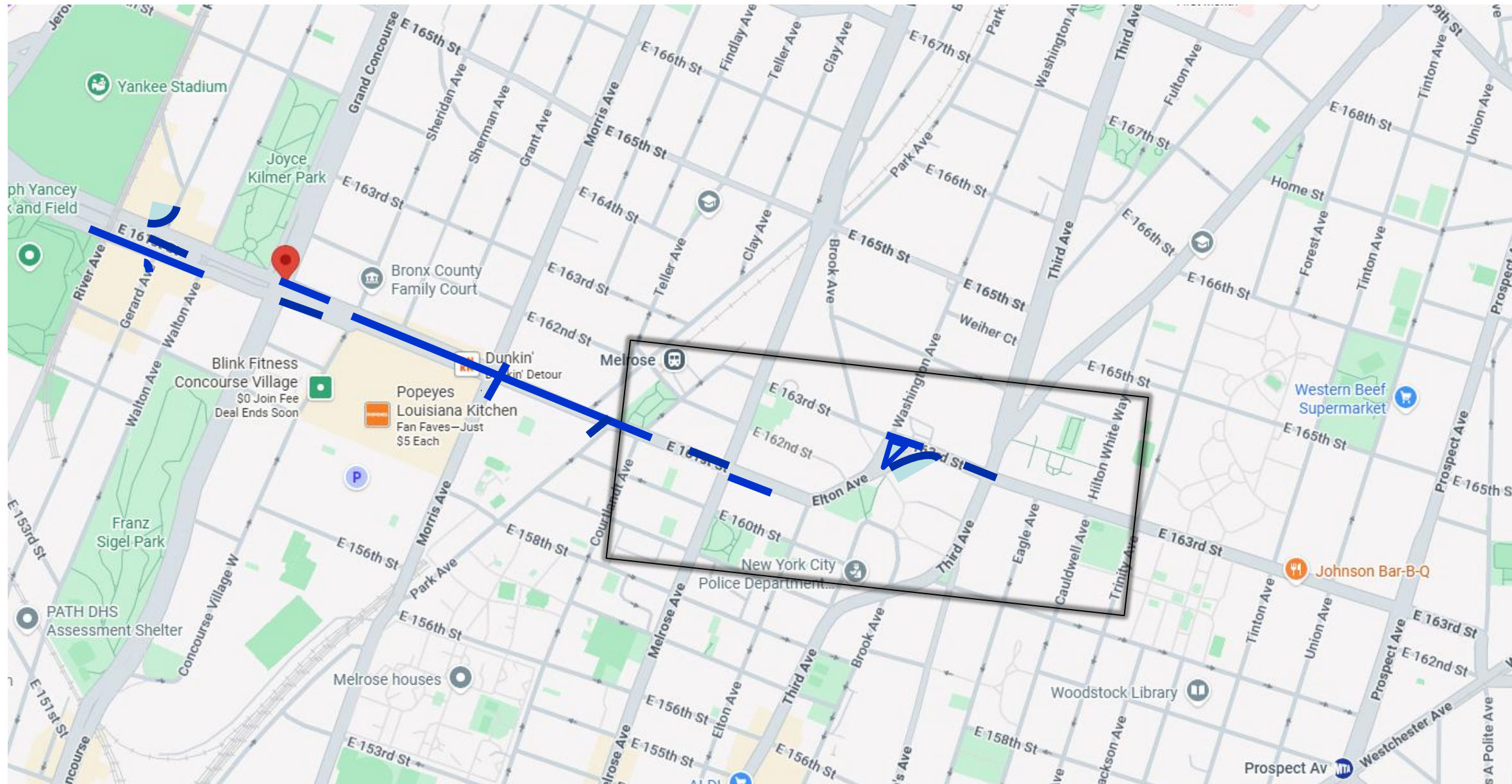

While there is only a small portion of water main being done within CB 3, the water main installation taking place in CB 4 may impact CB 3 and require shutdowns within the area.



- On E 161<sup>st</sup> St between Park Ave to Elton Ave
- E 163<sup>rd</sup> St between Washington and Elton Ave

# TYPICAL MAINTENANCE AND PROTECTION OF TRAFFIC

## TYPICAL MAINTENANCE AND PROTECTION OF TRAFFIC

(VARY DEPENDING ON WORK OPERATIONS AND LOCATIONS)

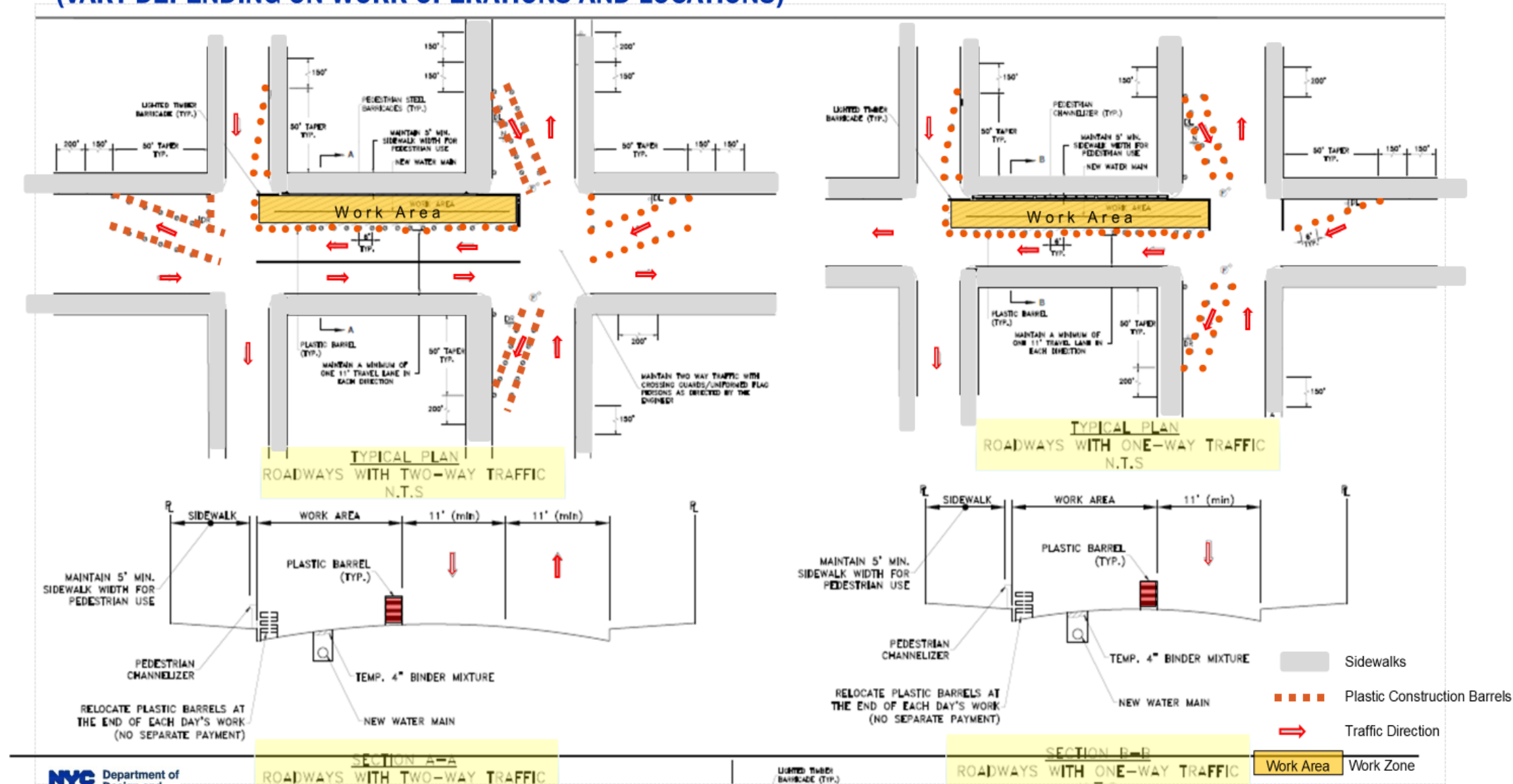

## Contract Provisions:

- **Traffic Enforcement Agents (TEAs)** have been approved on this project to maintain traffic flow.
- **GC will provide flaggers** at key points throughout work zones, to safely maintain movement of construction vehicles.

Requires DOT – OCMC Coordination of MPTs

3



For illustration purposes only



# COMMUNITY IMPACTS DURING CONSTRUCTION

- Roadway lane closures when necessary
- Temporary loss of parking within certain work zones
- Temporary relocation of bus stops
- Scheduled water main service shut-downs
- Weekend hours for construction may be necessary  
(allowable hours: Sat 8am-4pm)
- Coordination with Street Vendors & Dining Out as needed

# MITIGATION TO THE COMMUNITY IMPACTS

## **Contractor shall:**

- Work within DEP Noise Code Regulations
- Keep storage site areas clean and safe
- Cover trucks delivering fill material
- Provide professional rodent control inspector to monitor/maintain Rodent Control Station
- Garbage pick-up may be affected and will be coordinated with appropriate stakeholders.
- Dust mitigation

## **TRAFFIC PATTERNS**

### **Contractors shall maintain the following:**

- Signage and personnel to ensure a safe work site for pedestrians and vehicles
- Maintain pedestrian access to sidewalks, crosswalks and buildings
- Maintain emergency/ through way traffic - one way, in both directions, at all times
- Plate and open roadway traffic, when site is unattended/ not in use
- Parking and driveway access may be restricted when necessary; coordination is done on a case-by-case basis, signs will be posted in advance of work to avoid towing of vehicles.
- Full roadway closures – intermittent and when necessary

# COMMUNITY OUTREACH PROCEDURES:

**Community Construction Liaison (CCL)** responsibilities are as follows:

- First point of contact, maintain on-site presence and communications.
- Identify, resolve, and/or proactively address issues and inquiries.
- Distribute advisories and weekly construction activities newsletter.
- Provide 72-hour and 24-hour (confirmation or cancellation) advisories for work impacts by email and door to door.
- Attend community board monthly DSC meetings and other community meetings as necessary, to keep the community informed of the project schedule and impacts.

# COMMUNITY OUTREACH/ CCL (CONT.)

- **DDC's Office of Community Outreach + Notification (OCON)** works with CB's, BID's, local businesses, and other community stakeholders impacted by construction.
- DDC has assigned a dedicated on-site Community Construction Liaison (CCL).
- The CCL assigned to this project is: Tara Figueroa, her information is listed below.

Email: [hwx100sbc.ccl@gmail.com](mailto:hwx100sbc.ccl@gmail.com)

Phone: 917-471-9825

Field Office Location: 400 E 167<sup>th</sup> St, 3<sup>rd</sup> fl

Bronx NY 10456

Field Office Hours: 7AM to 3:30PM

DDC Project Lead: Jahneille Edwards, [EdwardsJa@ddc.nyc.gov](mailto:EdwardsJa@ddc.nyc.gov) 917.554.0821

# COMMUNITY CONSTRUCTION LIAISON INVOLVEMENT

## Keeping You Informed

The on-site CCL works directly with the project team. CCL will address community concerns, respond to inquiries, attend meetings, as needed, as well as distribute project related materials to keep the community informed and notified.

### PROJECT INFORMATION CARD (PIC)



### ADVISORIES



### WEEKLY LOOK AHEAD BULLETIN

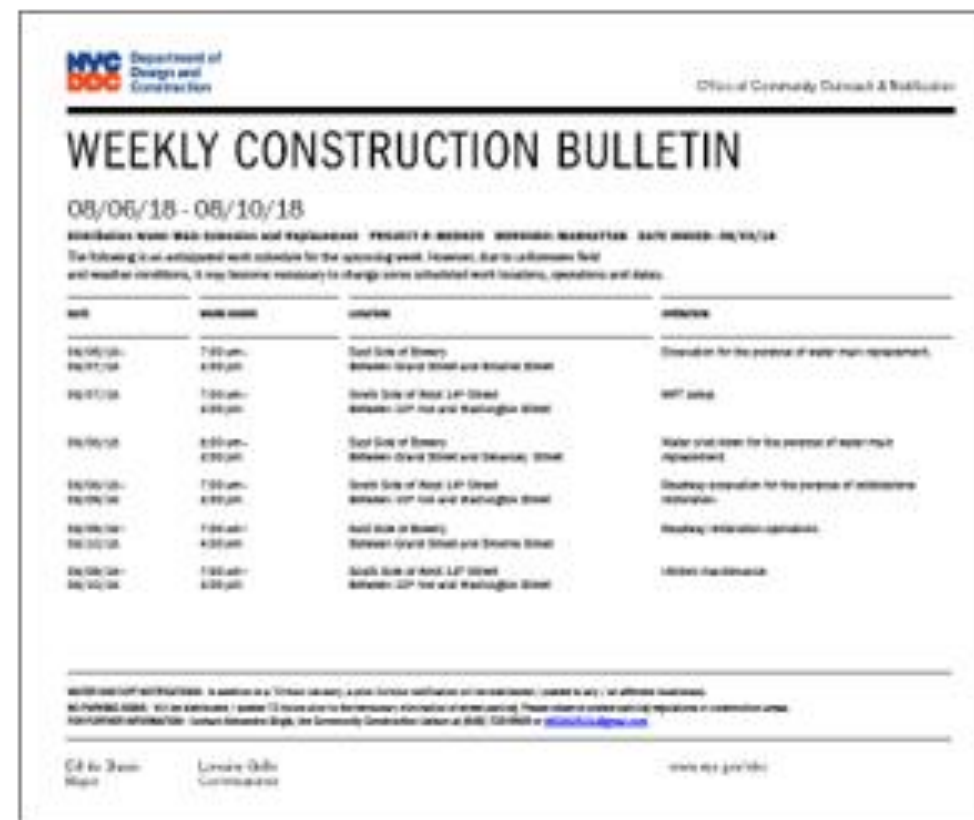

### QUARTERLY UPDATES



# PROJECT SCHEDULE

- **Design Completion - September 2024**
- **Construction Start - Early 2026**
- **Anticipated Construction Completion – Summer/Fall 2028**

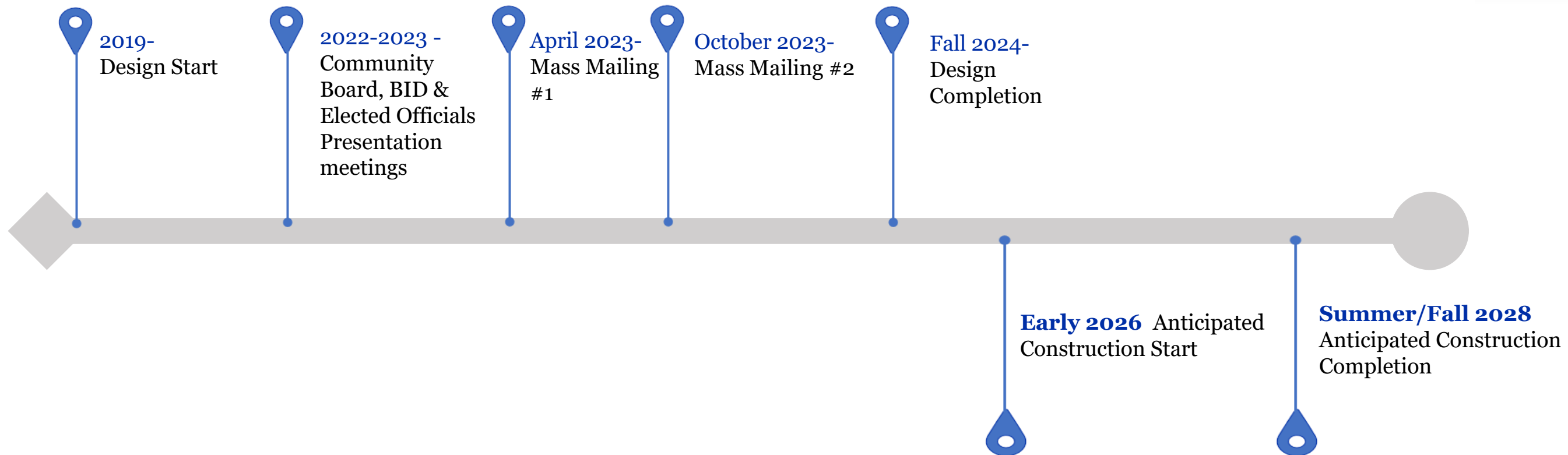



---

# THANK YOU

## Q&A

Zohran K Mamdani  
Mayor

Eduardo Del Valle  
Acting Commissioner